

2024K ROAD REHAB: HIGH DENSITY MINERAL BOND

RFP: 2024-006

PID: CIPTR-2024K



NOTES:

1. CONTRACTOR SHALL VISIT THE SITE TO BECOME ACQUAINTED WITH THE PROJECT AND ITS LIMITS PRIOR TO BIDDING.
2. CONTRACTOR SHALL NOTIFY THE CITY 48 HOURS PRIOR TO BEGINNING CONSTRUCTION.
3. ALL PAVING INSTALLATIONS SHALL BE SUBJECT TO CITY INSPECTION PRIOR TO THEIR BACKFILL. NO HMAC SHALL BE LAID PRIOR TO CITY INSPECTION.
4. CONTRACTOR SHALL MARK WITH PAINT LIMITS OF STREET REHAB FOR REVIEW & APPROVAL PRIOR TO CITY INSPECTION.
5. ALL CONSTRUCTION ACTIVITIES SHALL BE DONE IN ACCORDANCE TO THE CITIES TECHNICAL STANDARD MANUAL AND DETAILS.
6. CONSTRUCTION SHALL COMPLY WITH ALL OSHA SAFETY REGULATIONS AND ADDITIONAL MEASURES AS DIRECTED BY THE CITY.
7. WHERE PAVEMENT IS TO BE CUT, THE EXIST. ASPH PVMT SHALL BE SAWCUT, REMOVED, AND REPAVED. ANY ADDITIONAL PVMT DAMAGE CAUSED OUTSIDE SAWCUT LINE AS A RESULT OF CONSTRUCTION ACTIVITIES, SHALL BE SAWCUT, REMOVED, AND REPAVED.
8. REFER TO SPECIFICATIONS AND DETAILS FOR ADDITIONAL NOTES AND INSTRUCTIONS.
9. CONTRACTOR SHALL MAINTAIN TRAFFIC FLOW AT ALL TIMES, VIA FLAGMEN, GUIDE VEHICLES, OR OTHER MEANS AS APPROVED BY THE CITY.
10. CONTRACTOR SHALL PRESENT A TRAFFIC CONTROL PLAN TO THE CITY PRIOR TO CONSTRUCTION.
11. CONTRACTOR SHALL INSTALL VALVE RISERS AND MANHOLE RISERS. THE CITY SHALL SUPPLY THE RISERS MATERIAL, CONTRACTOR TO PERFORM INSTALL DURING PAVING OPERATION. NO SEPARATE PAY APP BUT SUBSIDIARY TO PAVING QUANTITIES.
12. CONTRACTOR SHALL USE A PLATE COMPACTOR TO COMPACTED TAPERED EDGE ON DESIGNATED ROADS.

SHEET INDEX

| | |
|-----|----------------|
| C01 | COVER SHEET |
| C02 | KEY MAP |
| C03 | HAMILTON ST |
| C04 | OAK ST |
| C05 | SHERRARD ST |
| C06 | 7TH ST |
| C07 | 6TH ST |
| C08 | 5TH ST |
| C09 | 3RD ST |
| C10 | N MAIN ST |
| C11 | CORDER LN |
| C12 | EVERGREEN CIR |
| C13 | N BOUNDARY ST |
| C14 | N VANDEVEER ST |
| C15 | N TANNER CT |

TCP DETAILS
TCP (1-2) -18

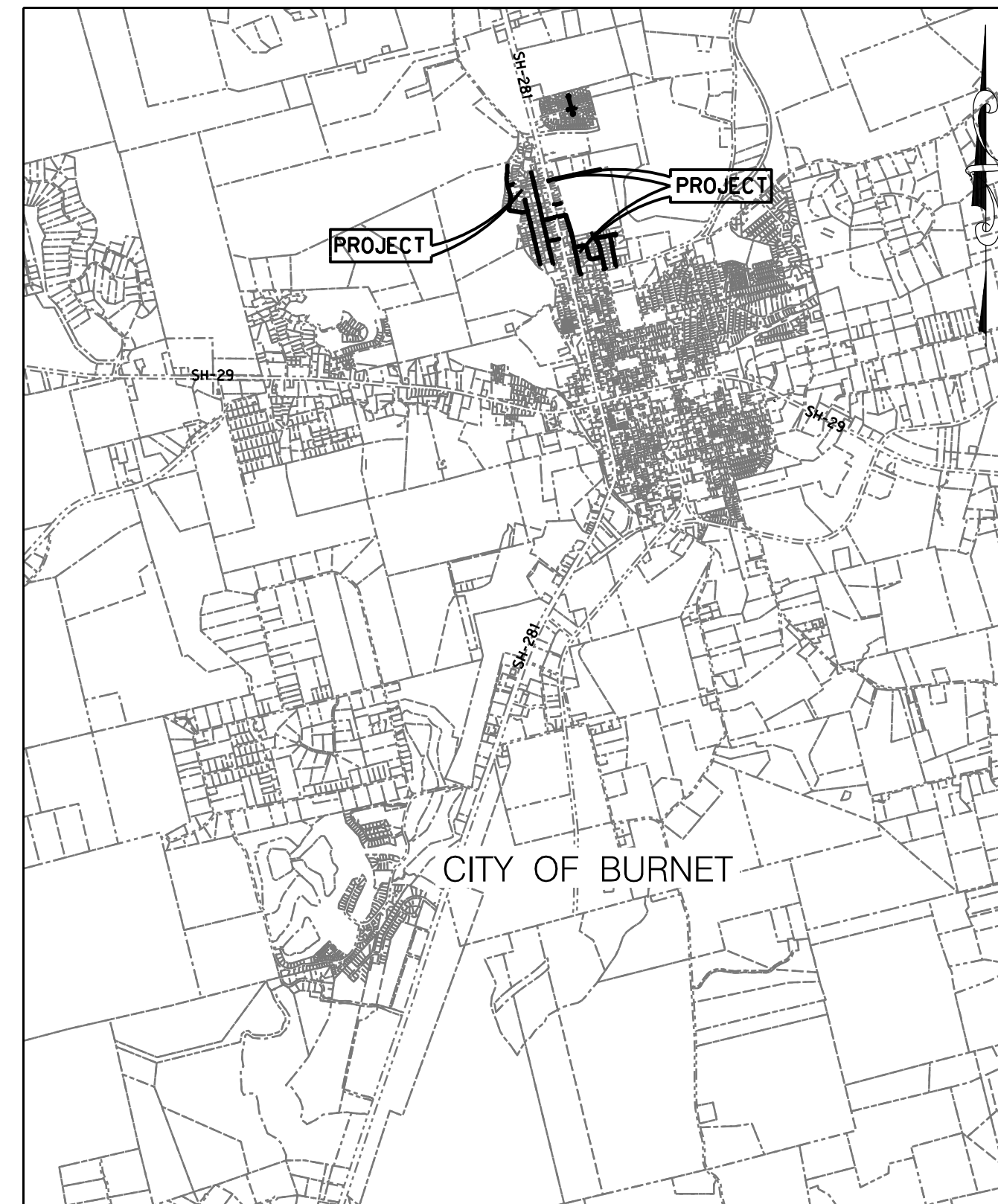

TOPOGRAPHIC SURVEY: DRAWINGS AND DESIGN ARE BASED ON GRID SYSTEM CTx NAD 83



LOCATION MAP
N.T.S.

D

C

B

A

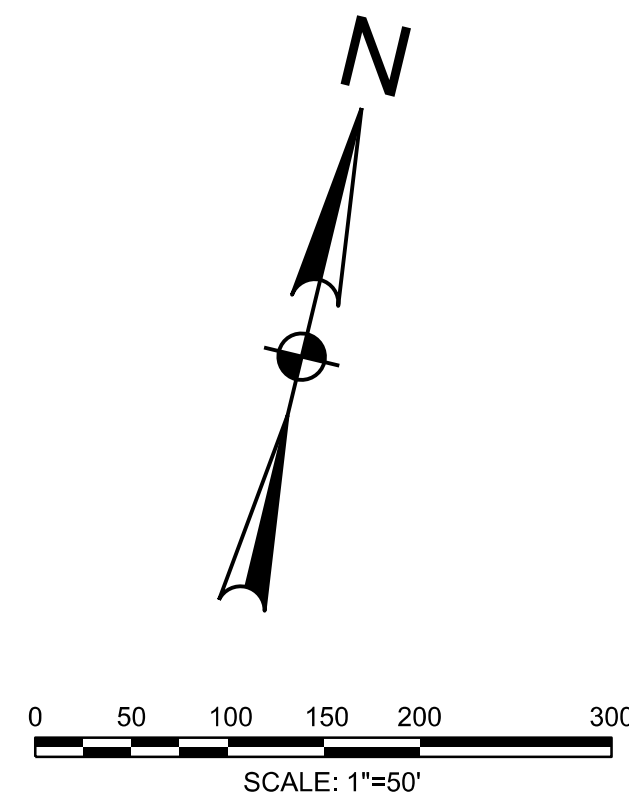

| LEGEND: | |
|---------|----------------------|
| | TY-III BARRICADE |
| | TRAFFIC CONTROL SIGN |
| | ARROW PANEL SUPPORT |
| | CHANNELIZING DEVICE |
| | SAFETY PERSONNEL |
| | TRAFFIC ROUTE |
| | WORKZONE THIS PHASE |
| | TRAFFIC BUTTON AT FH |
| | STOP BAR (TYP.) |

NOTES:

1. SEE ADDITIONAL NOTES ON COVER SHEET AND KEY MAP.
2. CONTRACTOR SHALL PREPARE CONSTRUCTION FLYERS AND PLACE THEM AT EACH RESIDENCE FRONTING THE STREET. THE FLYER SHALL FIRST BE PRESENTED TO THE CITY FOR APPROVAL.
3. CONTRACTOR SHALL SUBMIT A TRAFFIC FLOW AND CONSTRUCTION SEQUENCING PLAN TO THE CITY FOR DISCUSSION AND APPROVAL. ON SOME STREETS THE CITY ANTICIPATES ONE LANE OF TRAFFIC BEING OPEN AT ALL TIMES. SEGMENTS, WHERE NO DETOUR IS POSSIBLE THE CONTRACTOR TO PROVIDE FLAGMEN.
4. PAVEMENT PREPARATION, FOGSEAL, AND STRIPING INSTALLATION SHALL CONFORM TO THE CITY'S SPECIFICATIONS.

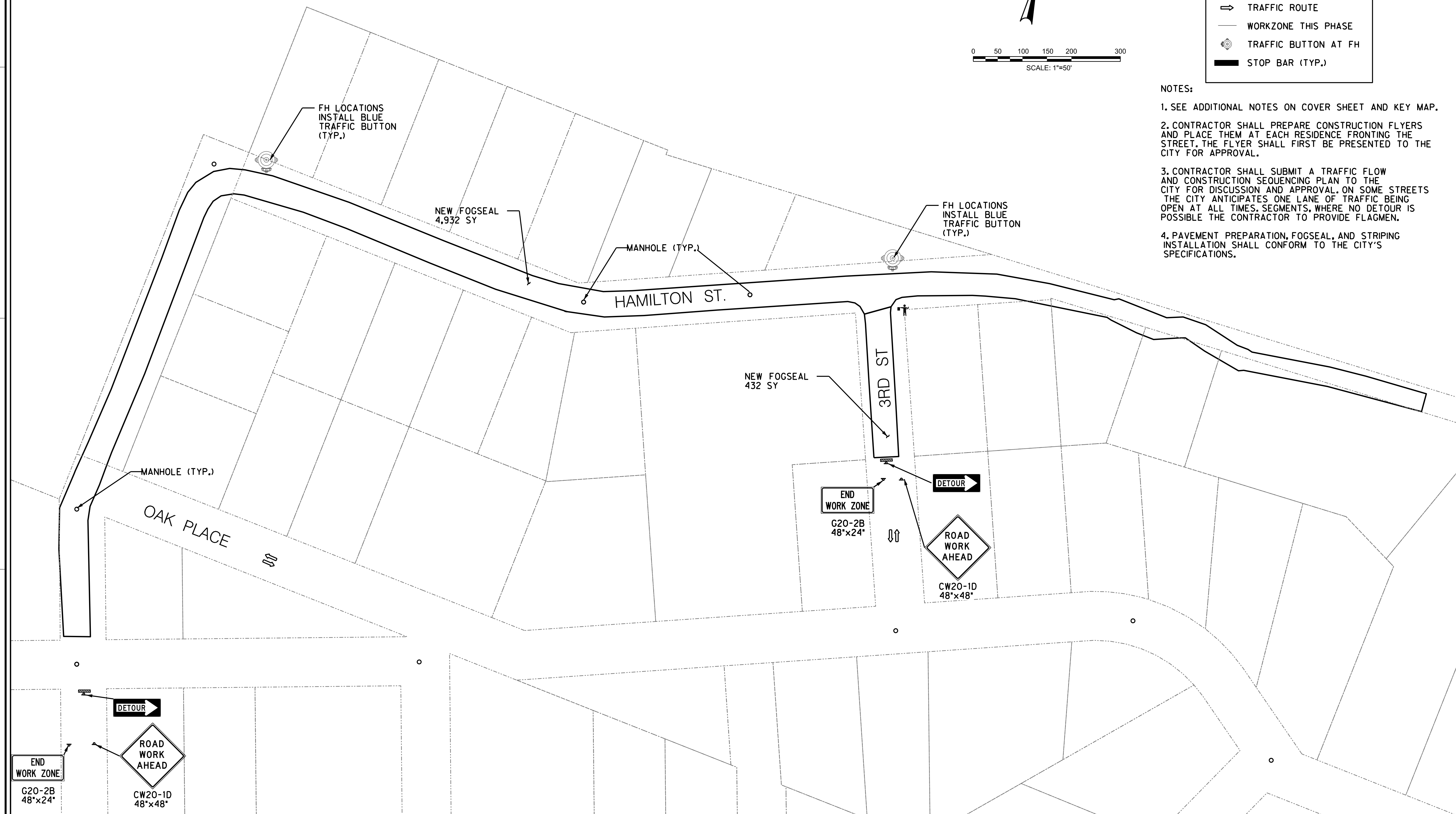

CITY OF BURNET
 1001 BUCHANAN DR. SUITE 04
 BURNET, TX 78611
 PH: (512) 756-6093

| NO. | DESCRIPTION | DATE | ID |
|-----|-------------|------|----|
| | | | |
| | | | |
| | | | |
| | | | |
| | | | |
| | | | |
| | | | |
| | | | |
| | | | |



2024K STREET REHAB PROGRAM
HAMILTON ST.

SHEET NO.
C03

